

GRU Universal Conduit Outlet Boxes

Explosionproof, Dust-Ignitionproof

UNILETS™ for use with Threaded Metal Conduit. Furnished with Internal Ground Screw. Furnished with O-ring.

NEC/CEC:

Class I, Division 1 and 2, Groups C, D
Class II, Division 1 and 2, Groups E, F, G
Class III

Applications

- Complies with a wide range of classified area requirements.
- Corrosion-resistant: ideal indoors or out.
- For pulling of wires.
- Connect conduit lengths and change direction of conduit runs.
- Provide access for maintenance.

Features

- Accurately tapped, tapered hub threads for tight, rigid joints and ground continuity.
- Furnished with covers.
- General purpose wiring.
- Universal design with five threaded universal hubs and three close-up plugs.
- Copperfree aluminum body and cover provide resistance to corrosive atmospheres.
- Internally threaded body and externally threaded cover with O-ring for raintight fit, NEMA 3, 4.
- Covers have pry notches for bar or wrench.
- Smooth, rounded integral bushing in each hub type box protects conductor insulation.

Standard Materials

- Bodies and covers: copperfree (4/10 of 1% max.) aluminum

Standard Finishes

- Bodies and covers: epoxy powder coat

NEC/CEC Certifications and Compliances

- UL Standard: UL 886 (UL 1203)
- UL Listed: E85310
- CSA Standard: C22.2 No. 25, C22.2 No. 30
- CSA Certified: 025875

Furnished with externally threaded aluminum surface cover, O-ring, five threaded hubs, and three close-up plugs.

For Form numbers designate body and matching cover sizes.

	Conduit Size (Inches)	Cover Body Opening mm (in)	Capacity dm ³ (in ³)	Form Number	Catalog Number
	1/2	85.9 (3.38)	0.22 (13.5)	1	GRU50-A
	3/4	85.9 (3.38)	0.22 (13.5)	1	GRU75-A
	1	85.9 (3.38)	0.29 (17.5)	1	GRU100-A ①

Dimensions in Millimeters (Inches)

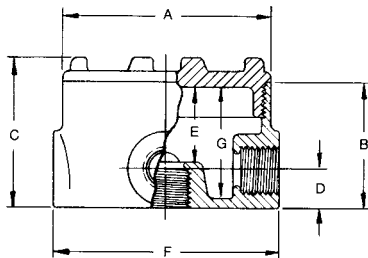

Hub Size Inches	Dimensions in Millimeters (Inches)						
	A	B	C	D	E	F	G
1/2	95.3 (3.75)	57.2 (2.25)	68.3 (2.69)	17.5 (0.69)	35.1 (1.38)	103.1 (4.06)	50.8 (2.00)
3/4	95.3 (3.75)	57.2 (2.25)	68.3 (2.69)	17.5 (0.69)	35.1 (1.38)	103.1 (4.06)	50.8 (2.00)
1	95.3 (3.75)	62.0 (2.44)	73.2 (2.88)	23.9 (0.94)	36.6 (1.44)	138.2 (5.44)	55.6 (2.19)

① Not UL or CSA Certified.